

LEASED



3/12 Mailey Street, Mansfield

Perched in one of the most elevated sections of "Broadwater Landing" this dual level townhouse captures nice local views and cooling breezes. The nicely maintained complex is filled with flowering gardens beds and offers the convenience of being just a few steps to express city bus stops and moments to schools and parks.

FEATURES INCLUDE:

- * Open plan living and dining areas which flow to outdoor courtyard
- * Spotless kitchen which offers great space and privacy
- * Three LARGE upper level bedrooms, all include built-in robes
- * Well-presented master bathroom, private balcony with views...

...

3  2  1 

Price: LEASED

View: <https://remaxexperience.com.au/7873871>

Leasing Team

M 0435 718 695

RE/MAX Experience

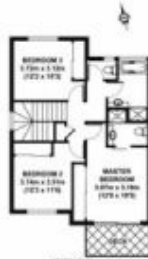

SECOND FLOOR
APPROXIMATE FLOOR AREA 353 SQ. M



FIRST FLOOR
APPROXIMATE FLOOR AREA 353 SQ. M

3-10 MAULEY STREET

APPROX. GROSS INTERNAL FLOOR AREA 127 SQ. M / 1367 SQ. FT.
APPROX. FLOOR AREA INCLUDING EXTERNAL AREAS 150 SQ. M / 1611 SQ. FT.

These plans are intended to provide a general impression of the proposed development and are not intended to be used for construction purposes. The developer is responsible for obtaining all necessary permits and approvals from the relevant authorities. The developer is not responsible for any errors or omissions in these plans. The developer is not responsible for any changes to these plans without the consent of the relevant authorities. The developer is not responsible for any damage to property or persons arising from the use of these plans. The developer is not responsible for any other matters not mentioned in these plans.

Created by: RMA, 2024. 04
www.rma.co.uk